



Olight Technology Co., Limited
www.olightworld.com
Tel: +86-755-3351 8606
Fax: +86-755-3380 0207
Email: olightworld@gmail.com

www.DrMemory.com/OLight



Operator' s Manual

SR51 Intimidator

Introduction

SR51 Intimidator

SR51 is one member of high power LED flashlights series made by Olight, it mounts latest in CREE XM-L U2 LED and drives LED to maximum capability, output luminous flux up to 900 lumens maximum, orange peer reflector enables smooth and wide light spot.

Suitable for outdoor adventure, hunting, searching and rescuing.

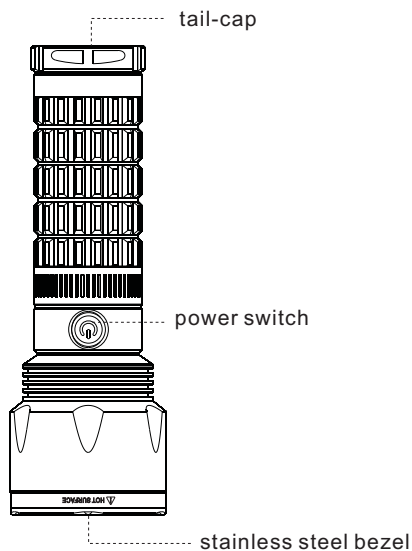

.1.

Specification

- LED: CREE XM-L U2 COOL WHITE
- Reflectors: Orange peel surface, aluminum alloy
- Battery: 6xCR123A/RCR123 or 2x18650 (Use matched battery carrier for different battery type)
- Operate Voltage: 4.5~8.4V
- Output Luminous Flux/Runtimes:
 - High Level: 900 lumens /110 minutes
 - Low Level: 250 lumens /10 hours
 - Strobe: 10Hz (frequency)
- Dimension: Head: D63mm(2.48in) Body: D43.8mm(1.85in)
Length: 190mm(7.48in)
- Material: Aluminum alloy body with type-III hard anodization
- Weight: 400g
- Color: Black
- Accessories: Lanyard x 1, Diffuser x 1, O-ring x 2, 18650 battery carrier x1(optional)

.2.

Features

- World-class CREE XM-L U2 LEDs, output up to 900 lumens max(OTF).
- 700 meters long throw, smooth light spot
- The highest efficient synchronous buck circuit enable power save, Max. 11 hours continual runtime
- One key for control operation
- Rugged indestructible aluminum body with anti-scratching type-III hard anodization. Engineered anti-slip knurling for tightly firm grip
- Firm stainless steel bezel
- Water proof IPX-8
- MIL-SPEC.: MIL-STD-810F
- Memory function (Exclude strobe mode)
- Lock function and unlock function

Battery Installation

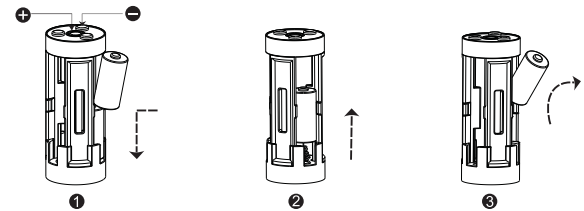

After you unfold the package, unscrew the tail and fetch out the battery carrier, then install batteries as above 1 (Please install the batteries toward right polarity) and insert the installed battery carrier into the body, then screw the tail. When you don't need to use the flashlights for long time, please fetch out the battery carrier and uninstall batteries as above 2 and 3(push the batteries upwards along the battery slot then fetch them out).

Operation Introduction

1. Power on/off the light

To power on the light, click power switch.

To shut off the output, click power switch.

2. Switch output mode

Under on state, press and hold power switch, the output switches between high level and low level, choose expected level then release the switch.

To enter into strobe mode, double click power switch under on state.

Under strode mode, click power switch will shut off the output, but press and hold power switch will enter into either high level or low level.

3. Lock and unlock

To lock the light, under on sate, press and hold power switch until the output shut off automatically. Under lock state, press the power switch will not power on the light. Usually we use lock function when we make transportation with batteries.

To unlock the light, quickly click the power switch 3 times within 1 second.

Warranty

Olight™ warrants its products to be free from defects in materials and workmanship. Within 30 days of receipt, any defective lights will be offered repair or replacement by the retailer where the product was purchased. Olight™ will repair or replace, at its option and without charge, any product or part which is found to be defective under normal use and service within 24 months counting from the date of purchasing with proof of purchase, Such repair or replacement shall be the purchaser's sole and exclusive remedy under this warranty, This warranty does not cover normal maintenance and service and does not apply to any products or parts which have been subject to modification, misuse, negligence, accident, improper maintenance or repair by anyone other than Olight™.

As to those exceed 24 months of the purchase date, Olight will still provide with warranty service. Labor is free but cost of parts will be charged. This warranty covers parts and labor only as specified above. Freight and transit costs are the responsibility of the user/owner; not the factory or dealer.

Warranty Limitation

There is no other express warranty. Olight hereby disclaims any and all implied warranties, including but not limited to fitness for a particular purpose.

Olight shall not be liable for incidental, consequential, or special damages arising out of, or connection with, product use or performance.