

OLIGHT

USER MANUAL

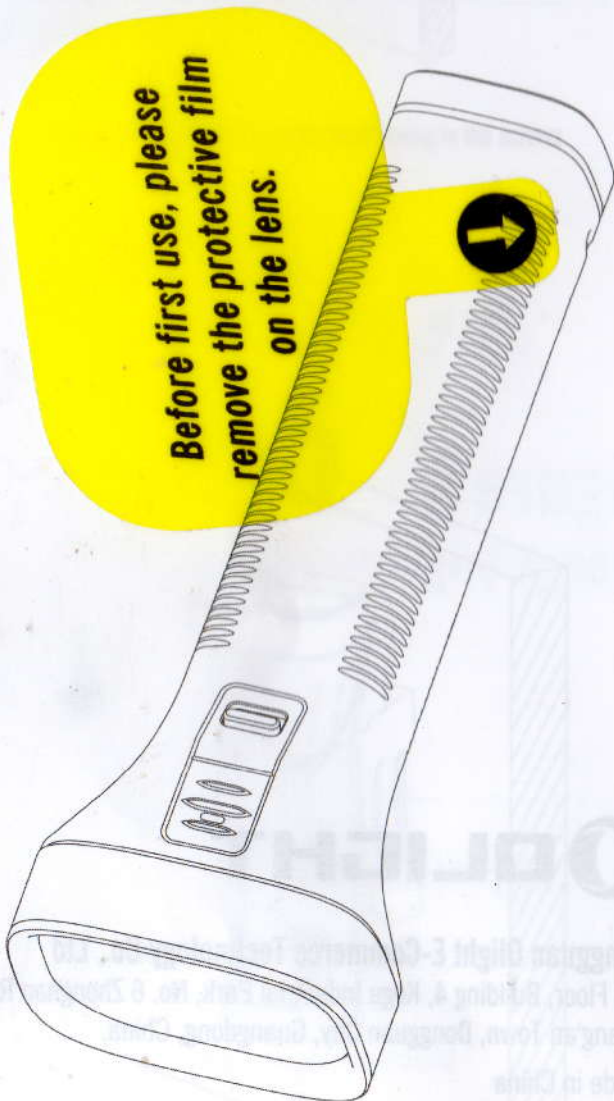

REGULUS

IN THE BOX

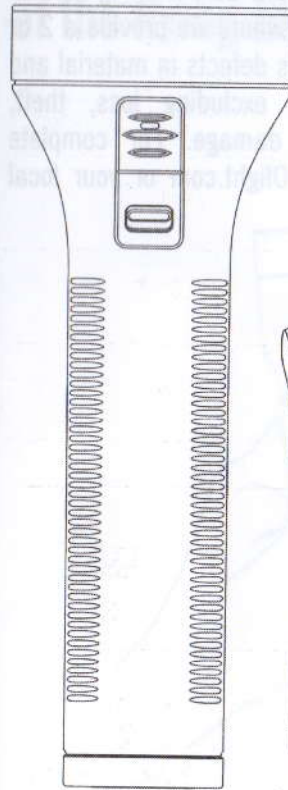

Regulus

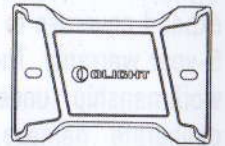

Holster Fixing Bracket

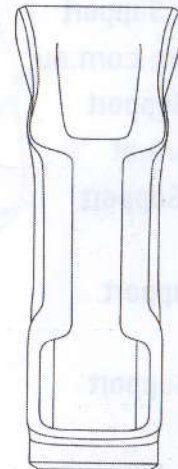

Holster



X2
Screws & Plastic
Screw Anchors

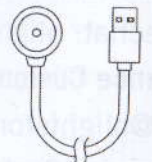

MCC

Table 1: Specifications

FLOODLIGHT
MAX OUTPUT: 18.5W

CCT: 6500K CRI: 70

TURBO	2400 lumens	100% 4min	33% 185min	8% 40min
HIGH	800 lumens	100% 200min	25% 40min	
MEDIUM	200 lumens	100% 15h		
LOW	20 lumens	100% 133h		
MOONLIGHT	1 lumen	100% 60days		

SPOTLIGHT
MAX OUTPUT: 12.2W

CCT: 6500K CRI: 65

TURBO	750 lumens	100%	7min	47%	220min	20%	20min
HIGH	350 lumens	100%	250min	43%	40min		
MEDIUM	150 lumens	100%			13.5h		
LOW	30 lumens	100%			72.5h		
MOONLIGHT	1 lumen	100%			60days		



5.5000cd



460m



1.5m



IPX8



220g / 7.76oz
 (Including Battery)



Working temperature
 0-40°C

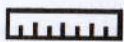

(L)126.5*(W)45.5*(H)35mm
 (L)4.98*(W)1.79*(H)1.38in



Rechargeable Li-ion Battery
 5000mAh 3.6V (18Wh)

* Above data are tested per ANSI/PLATO FL 1-2019 standard in Olight's labs for reference.

Table 2: USB Magnetic Charging Cable

Cable length	0.5m
Input	5V 2A
Output	CC&CV 4.2V 2.0A
Time to fully charge	About 4.5 hours

Figure 1

Remove the insulating film and lens protective film before use

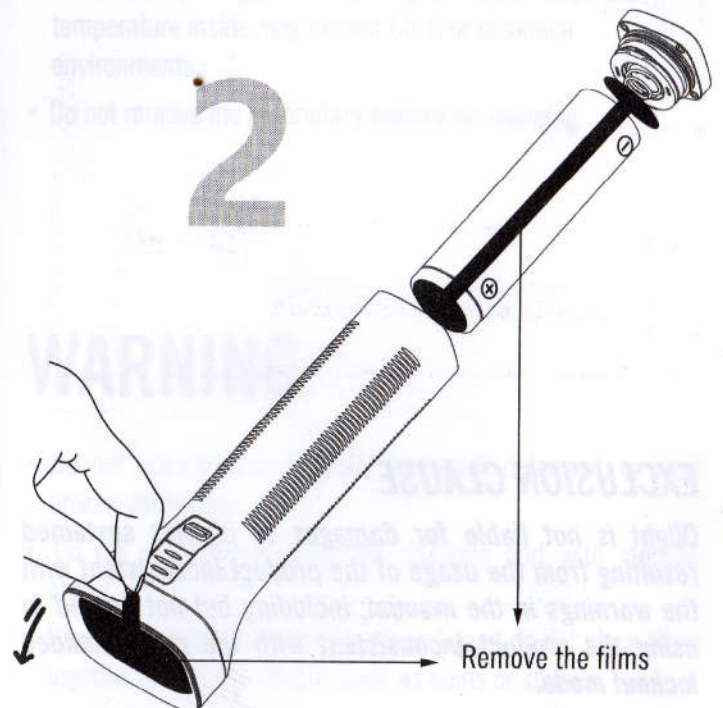
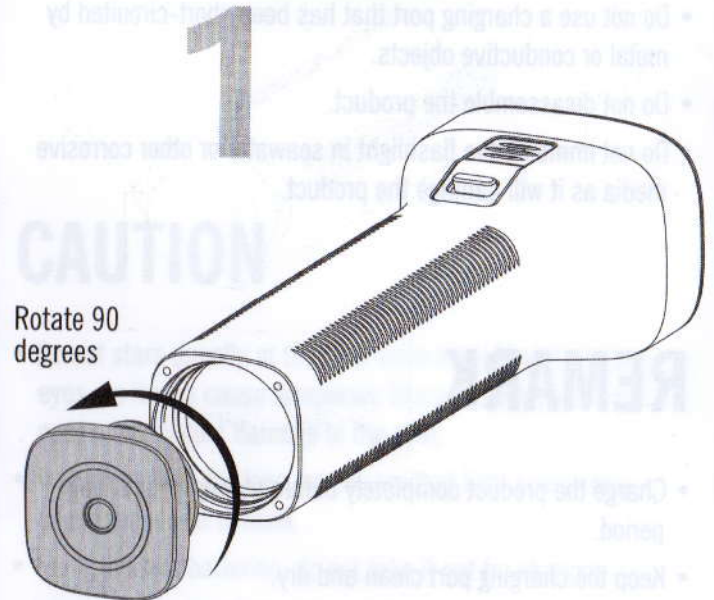

Figure 2

Charge

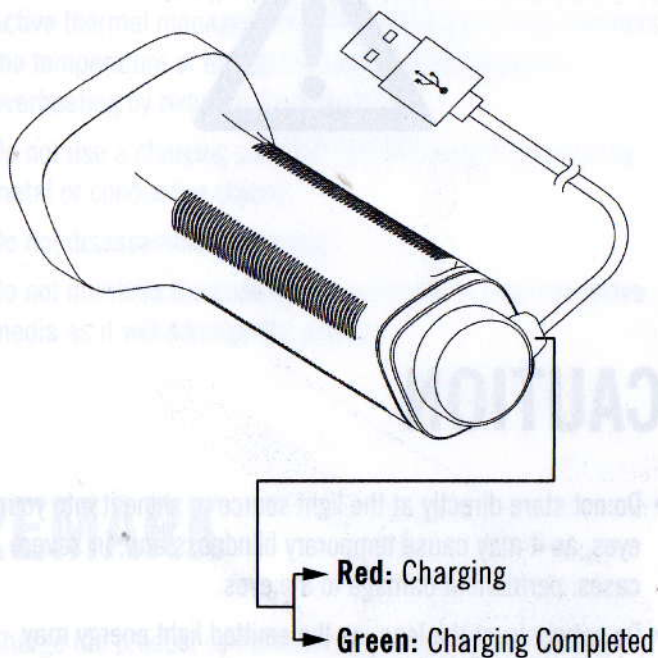
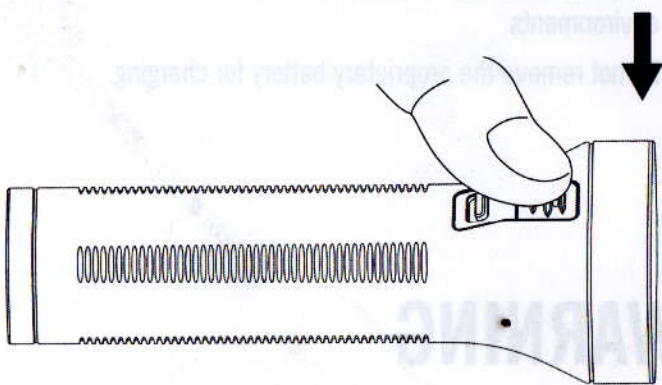

Figure 3

ON/OFF



Press



Figure 4

Lock/Unlock

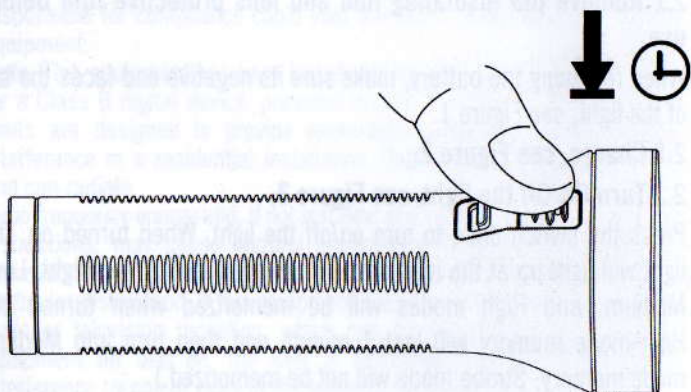

Press and hold



> 1 sec



> 2 sec



Figure 5

Select floodlight and spotlight

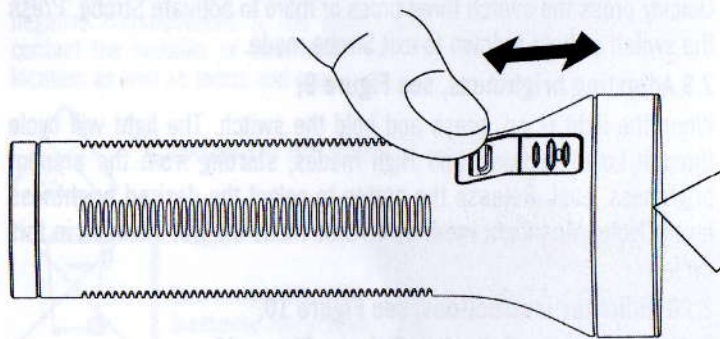

Toggle modes



Spotlight



Floodlight

Figure 6
Moonlight

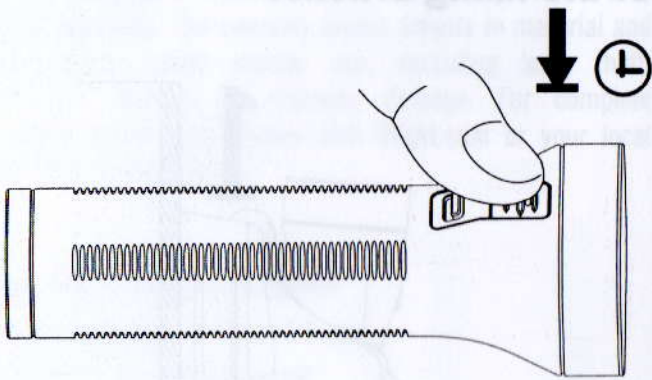

Press and hold



1 to 2 sec



Moonlight

Figure 8
Strobe

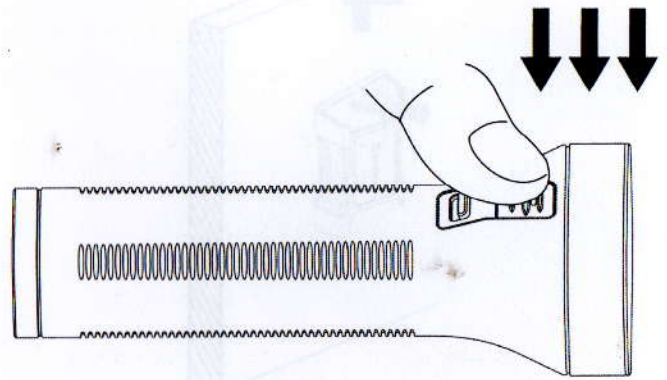

Triple press



Or

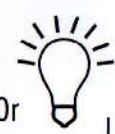

Strobe

Figure 7
Turbo

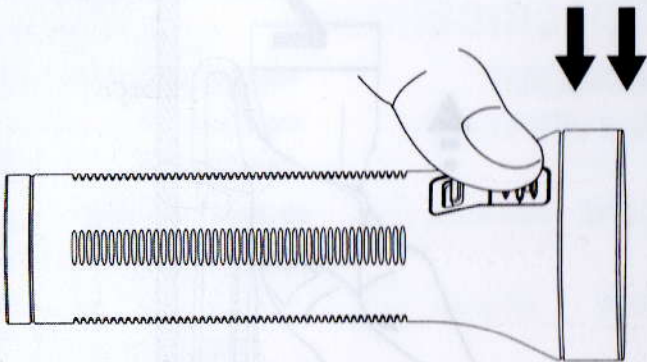

Double press



Or



Figure 9
Change brightness level

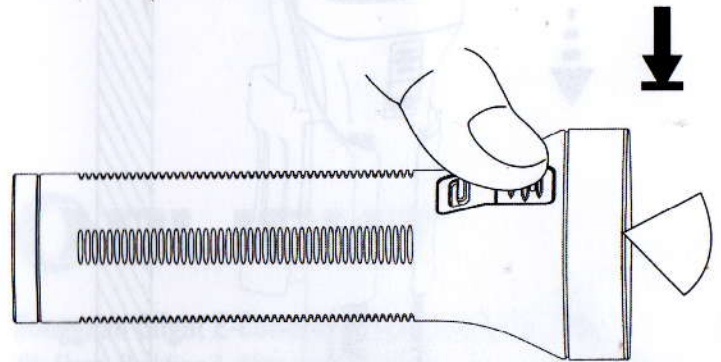

Press and hold

Moonlight

Turbo

Low

High

Medium

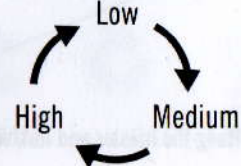
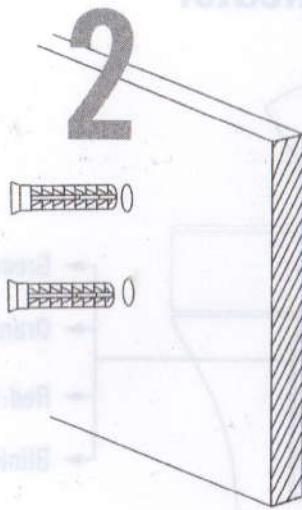
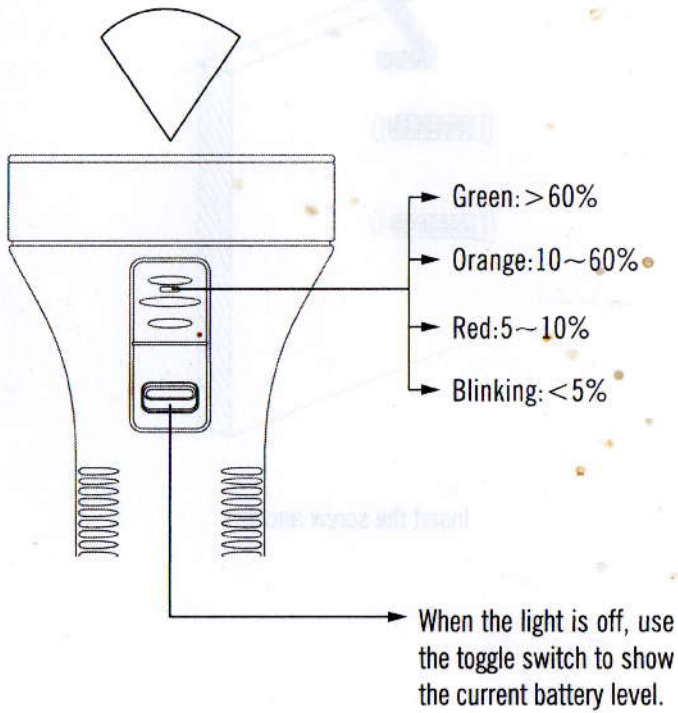

Figure 10

Battery indicator



Insert the screw anchors

Figure 11

How to use the fixing bracket

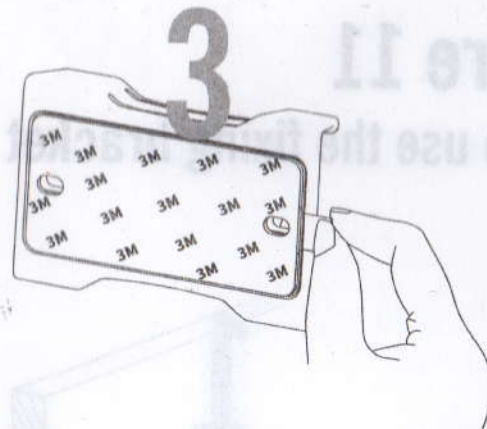
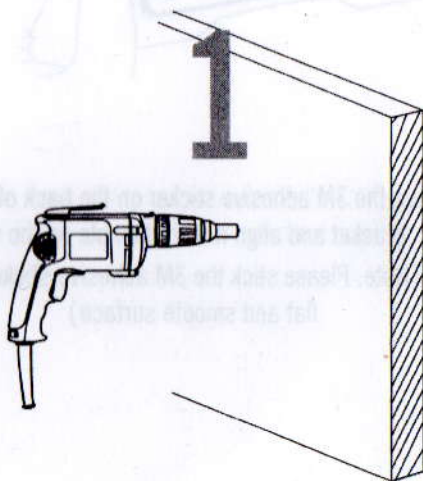

Remove the 3M adhesive sticker on the back of the fixing bracket and align it with the hole on the wall
(Note: Please stick the 3M adhesive sticker on a flat and smooth surface)

Use tools to punch holes in the wall or wooden board

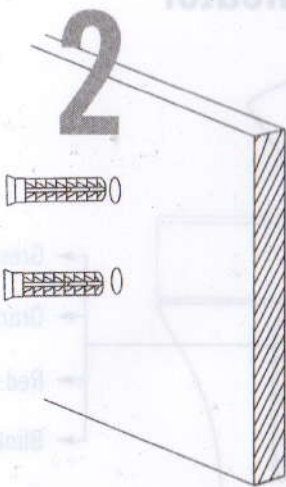

Insert the screw anchors

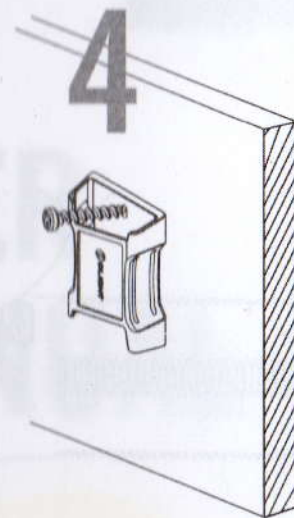

Secure the bracket in place by screwing in the screws

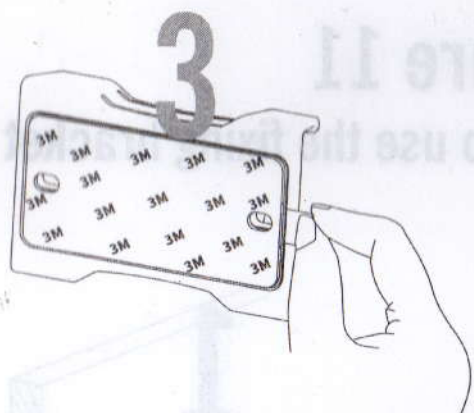

Remove the 3M adhesive sticker on the back of the fixing bracket and align it with the hole on the wall
(Note: Please stick the 3M adhesive sticker on a flat and smooth surface)

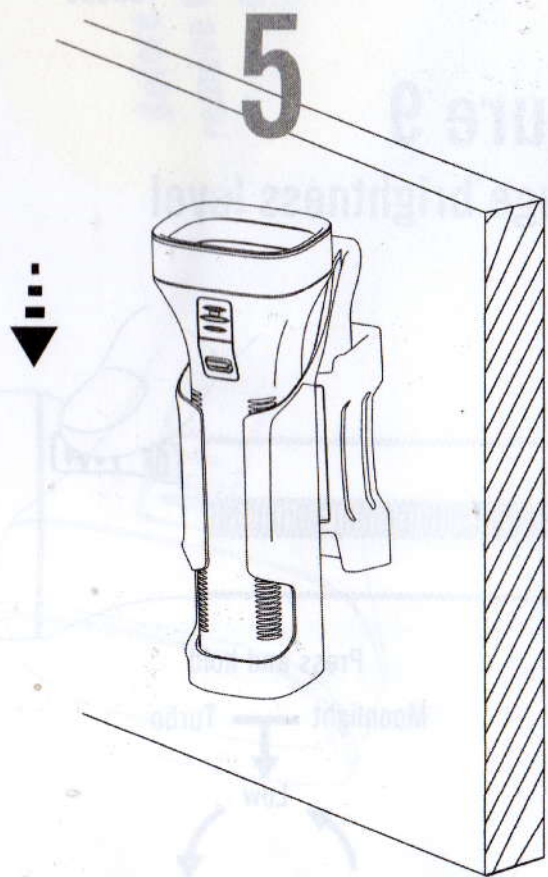

Hang the holster and flashlight

Figure 12

How to take the vertical holster out of the fixing bracket

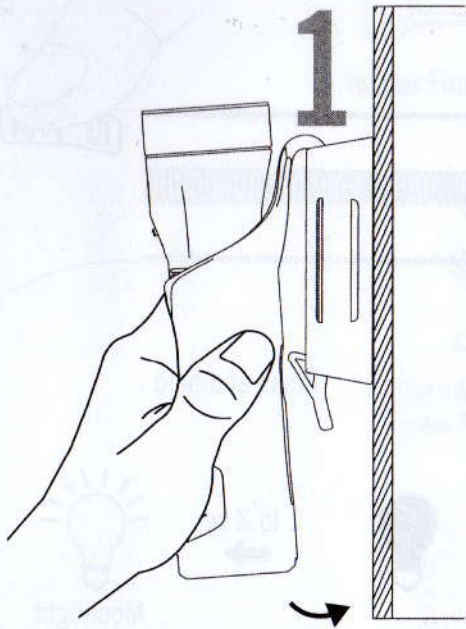

Press the vertical holster against the fixing bracket

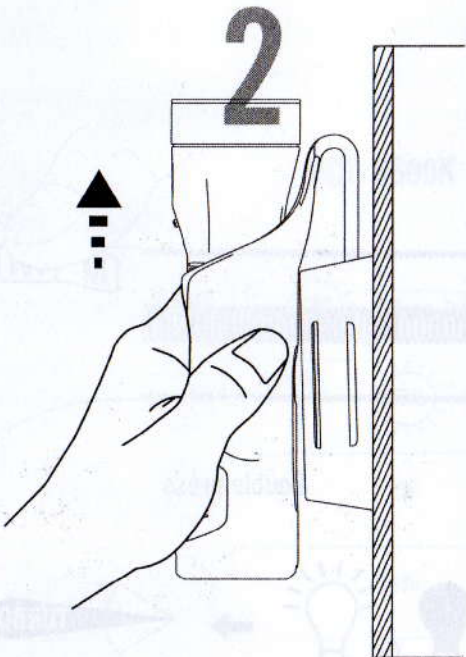

Pull

How to operate:

1. Product specifications, see Table 1 and Table 2;

2. Product instructions as below:

2.1 Remove the insulating film and lens protective film before use.

When replacing the battery, make sure its negative end faces the tail of the light, see Figure 1.

2.2 Charge, see Figure 2;

2.3 Turn On/Off the light, see Figure 3;

Press the switch once to turn on/off the light. When turned on, the light will light up at the memorized brightness level. (Moonlight, Low, Medium, and High modes will be memorized when turned off. High-mode memory will last 1 minute and then turn into Medium mode memory; Strobe mode will not be memorized.)

2.4 Lock/Unlock, see Figure 4;

To lock the switch, when the light is off, press and hold the switch (for about 2 seconds) until the Moonlight turns off. To unlock, press and hold the switch (for about 1 second) until the Moonlight turns on. When locked, the indicator turns red when you press the switch.

2.5 Switch between spotlight/floodlight, see Figure 5;

Use the toggle switch to switch between spotlight and floodlight. (Note: When the light is in Low mode, it automatically changes to Medium output when switching the light source.)

2.6 Moonlight mode, see Figure 6;

To activate Moonlight mode, press and hold the switch (for about 1 second) when the light is off. If the last used mode was Moonlight mode, simply press the switch.

2.7 Turbo mode, see Figure 7;

Quickly double press the switch to activate Turbo.

2.8 Strobe mode, see Figure 8;

Quickly press the switch three times or more to activate Strobe. Press the switch or hold it down to exit Strobe mode.

2.9 Adjusting brightness, see Figure 9;

When the light is on, press and hold the switch. The light will cycle through Low, Medium, and High modes, starting from the present brightness level. Release the button to select the desired brightness level. (Note: Moonlight mode and Turbo mode are not included in this cycle.)

2.10 Indicator instructions, see Figure 10;

3. How to use the fixing bracket, see Figure 11;

Use tools to punch holes in the wall or wooden board, then insert the plastic screw anchors. Remove the 3M adhesive sticker on the back of the fixing bracket and align it with the hole in the wall, then secure the bracket in place by screwing in the screws. (Note: Please stick the 3M adhesive sticker on a flat and smooth wall or car panel.)

3.1 Remove the light from the fixing bracket, see Figure 12.

Press the light towards the fixing bracket and then pull it upwards.

NOTICE

- Do not put a hot light into any type of fabric bag or fusible plastic container.
- Active thermal management: The built-in thermistor monitors the temperature of the light in real time and prevents overheating by reducing the output.
- Do not use a charging port that has been short-circuited by metal or conductive objects.
- Do not disassemble the product.
- Do not immerse the flashlight in seawater or other corrosive media as it will damage the product.

REMARK

- Charge the product completely before storing it for a long period.
- Keep the charging port clean and dry.
- When the battery voltage is low, the maximum working brightness is 200 lumens.

EXCLUSION CLAUSE

Olight is not liable for damages or injuries sustained resulting from the usage of the product inconsistent with the warnings in the manual, including but not limited to using the product inconsistent with the recommended lockout mode.

FCC Compliance Statement

This device complies with part 15 of the FCC Rules. Operation is subject to the following two conditions:

- (1) This device may not cause harmful interference, and
- (2) this device must accept any interference received, including interference that may cause undesired operation.

Any changes or modifications not expressly approved by the party responsible for compliance could void the user's authority to operate the equipment.

Note: This equipment has been tested and found to comply with the limits for a Class B digital device, pursuant to part 15 of the FCC Rules. These limits are designed to provide reasonable protection against harmful interference in a residential installation. This equipment generates uses and can radiate

radio frequency energy and, if not installed and used in accordance with the instructions, may cause harmful interference to radio communications. However, there is no guarantee that interference will not occur in a particular installation. If this equipment does cause harmful interference to radio or television reception, which can be determined by turning the equipment off and on, the user is encouraged to try to correct the interference by one or more of the following measures:

- Reorient or relocate the receiving antenna.
- Increase the separation between the equipment and receiver.
- Connect the equipment into an outlet on a circuit different from that to which the receiver is connected.
- Consult the dealer or an experienced radio/TV technician for help.

EU Declaration of Conformity

Hereby Dongguan Olight E-Commerce Technology Co.,Ltd declares that the equipment [Regulus] is in compliance with Directive 2014/30/EU and RoHS Directive 2011/65/EU & (EU) 2015/863. The full text of the EU declaration of conformity is available at the following internet address:
<https://www.olight.com/download>

The light source of this luminaire is not replaceable: when the light source reaches its end of life the whole luminaire shall be replaced

WEEE Disposal and Recycling Information

All products bearing this symbol are waste electrical and electronic equipment (WEEE as in directive 2012/19/EU) which should not be mixed with unsorted household waste. Instead, to protect human health and the environment, you should dispose of your waste equipment at a designated collection point for the recycling of WEEE, appointed by the government or local authorities. Proper disposal and recycling will help prevent potential negative consequences to the environment and human health. Please contact the installer or local authorities for more information about the location as well as terms and conditions of such collection points.



Caution-Do not stare at operation light source.



FR

Les ampoules et batterie recyclent

À DÉPOSER
EN MAGASIN

À DÉPOSER
EN DÉCHÈTERIE



OU



Points de collecte sur www.auefairedemesdechets.fr



FR



ETUI



TUBE



WARRANTY

We are proud to offer a lifetime warranty in Australia, China, France, Germany, and the USA. We are also working hard to expand coverage to more countries, where we provide a 2 or 5-year warranty. The warranty covers defects in material and workmanship under normal use, excluding loss, theft, deliberate damage, or cosmetic damage. For complete warranty information, please visit Olight.com or your local Olight official website.

Australia Customer Support

contact@olightstore.com.au

Austria Customer Support

kontakt@olightstore.at

Canada Customer Support

cs@olightstore.ca

China Customer Support

Wechat: [olightcs](https://www.woahome.com)

France Customer Support

cs@olightstore.fr

Germany Customer Support

kontakt@olightstore.de

Italy Customer Support

contatto@olightstore.it

Japan Customer Support

cs@olightstore.jp

Korea Customer Support

olightkorea@olight.com

Spain Customer Support

contacto@olightstore.es

Thailand Customer Support

cs@olightstore.co.th

UK Customer Support

contact@olightstore.uk

USA Customer Support

cs@olightstore.com

**For other countries and regions, please contact
Global Customer Support**

contact@olight.com

OLIGHT

Dongguan Olight E-Commerce Technology Co., Ltd

4th Floor, Building 4, Kegou Industrial Park, No. 6 Zhongnan Road,
Chang'an Town, Dongguan City, Guangdong, China.

Made in China



3.4000.0667

A. 05, 23, 2024



CAUTION

- Do not stare directly at the light source or shine it into your eyes, as it may cause temporary blindness and, in severe cases, permanent damage to the eyes.
- Do not obstruct the lens, as the emitted light energy may cause the object to burn.
- Non-standard batteries, do not take it out for charging.
- Do not charge the light with any chargers that are not specified.
- Do not touch the hot surface, or else it may cause skin burns.
- Do not store, charge, or use this light in a car where the temperature inside may exceed 60°C or in similar environments.
- Do not remove the proprietary battery for charging.

WARNING

- Do not use batteries that are damaged, deformed, or have broken packaging.
- Do not intentionally short the charging port with metallic object.
- Handle the removed batteries properly and do not place them together with metal objects such as coins or screws.

READ ME

- 1 Before first use, please unscrew the tailcap and remove the insulating film. If the battery needs to be replaced, make sure that the positive end of the new battery faces the flashlight head when you put it in.

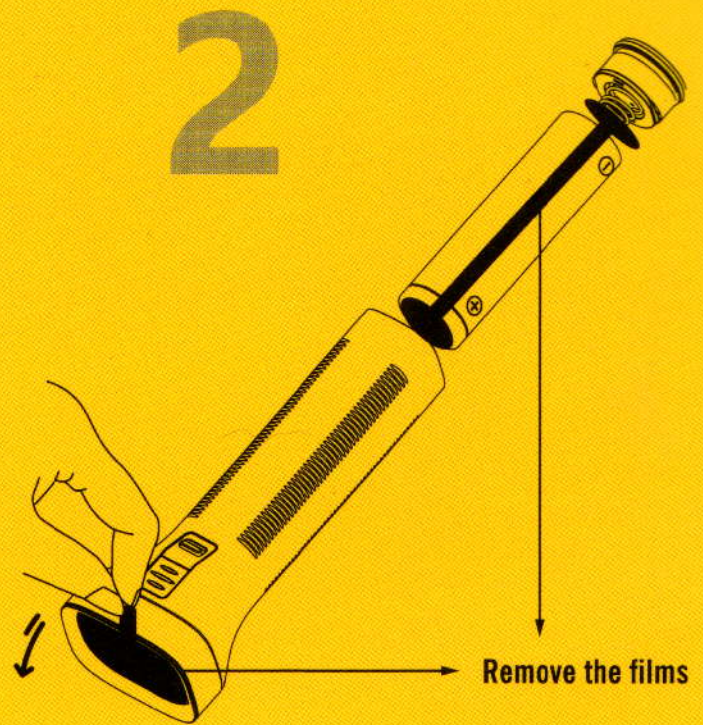
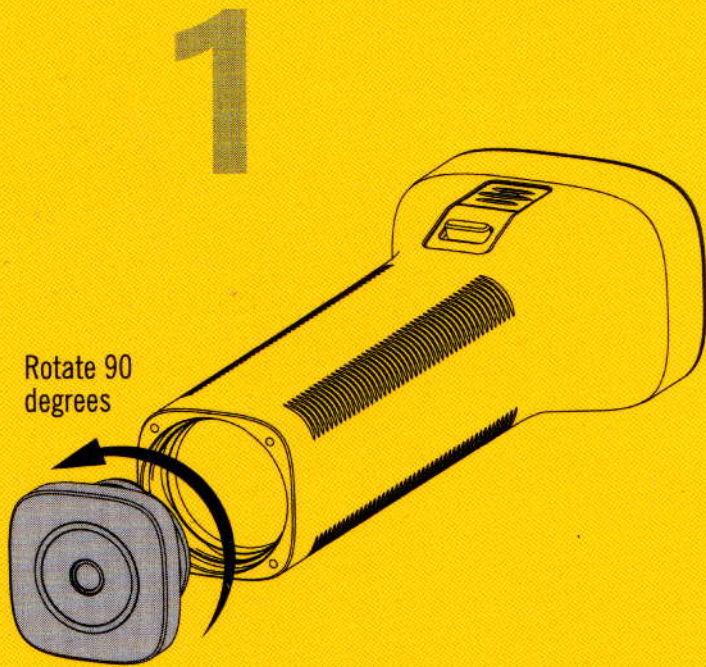

- 2 Please charge it fully before you turn it on.

