

## WARRANTY

Within 30 days of purchase: Return to the retailer which you purchased from for repair or replacement;

Within 5 years of purchase: Return to Olight for repair or replacement.

Note: Excluding batteries, battery pack, accessories and other products which warranty period had been declared.

This warranty does not cover normal wear and tear, modifications, misuse, disintegrations, negligence, accidents, improper maintenance, or repair by anyone other than an authorized retailer or Olight itself;

## Technical Support Inquiries

techsupport@olightworld.us

## Customer Service

cs@olightworld.us

Visit [www.olightworld.com](http://www.olightworld.com) to see our complete product line of portable illumination tools.



Olight Technology Co., Limited  
Address: 2/F, Building A, B3 Block,  
Fuhai Industrial Park, Fuyong, Bao'an  
District, Shenzhen, China 518103



MADE IN CHINA

V1. 03, 04, 2016



[www.DrMemory.com/Olight](http://www.DrMemory.com/Olight)



## S2-Cu BATON USER MANUAL

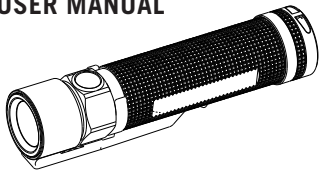

Thank you for purchasing the Olight product! Please read this manual carefully before using this product.

## INSIDE THE BOX

S2-Cu Baton, battery magazine, lanyard, traffic wand, manual.

## FLASHLIGHT SPECIFICATIONS

Material: Copper, stainless steel clip.

 142 m	 MAX 950 lumens	 5,000 cd	 IPX8
 1.5 m	 Cree XM-L2 CW	 1 x 18650 or 2 x CR123A	
 10 Hz	 (L)103 x (D)23 mm	 112 g excluding battery	

## OUTPUT & RUNTIME

	1 x 18650 (3.6v 3400mAh)	2 x CR123A (3.0v 1500mAh)
<b>TURBO</b> (950~500 lm)	⌚ 2+170 min	⌚ 2+100 min
<b>HIGH</b> (400 lm)	⌚ 245 minutes	⌚ 165 minutes
<b>MEDIUM</b> (80 lm)	⌚ 19 hours	⌚ 12 hours
<b>LOW</b> (10 lm)	⌚ 144 hours	⌚ 95 hours
<b>MOONLIGHT</b> (0.5 lm)	⌚ 60 days	⌚ 35 days

## BATTERY INSTALLATION

Install the battery as shown on Figure. Ensure the battery positive towards the tailcap.

## SUPPORTED BATTERIES

- 1 x 18650 or 2 x CR123A

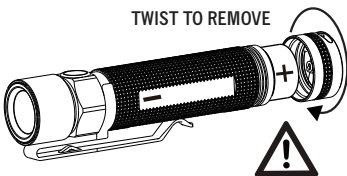

## HOW TO OPERATE

**ON/OFF:** To turn on the light, single-click the side switch, the flashlight outputs at memorized brightness level, single-click again will turn the light off.

### CHANGE BRIGHTNESS LEVEL:

Press and hold the side switch when the light is on. The output will cycle through low – medium – high – turbo mode. Release the side switch when the desired brightness level is achieved.

**MOONLIGHT:** From off state, press then hold the side switch for 1 second enables the low-lumen moonlight.

**DIRECT ACCESS TO TURBO:** From off state, double clicks directly activate turbo mode.

**STROBE:** While on, triple-click the side switch to activate strobe mode, any other operation will quit the strobe.

**TIMER:** The light contains two timer settings: long timer (9minutes) and short timer (3 minutes). Double

click the side switch to enter this setting. short timer blink once for 3 minutes, long time blink 2 times for 9 minutes. Double click the side switch to change the timer to the opposite setting. The light will automatically shut off when the timer is over.

## NOTICE

- Memorization can be used with these five modes listed: low, medium, high, turbo and timer mode, but the turbo mode activated by double-click on the side switch will not be memorized. If you turn the light on at high and turn it back on again longer than 10 minutes, the light will return to medium instead of high.

- Standard brightness mode changing does not include moon light mode. With the moon light mode on, click and hold the side switch to activate the standard brightness modes.

- The turbo mode can last for 2 minutes. The high output ramps down by 50% within 1 minute of constant on.

- The light does not memorize strobe mode. When the strobe mode is deactivated, the memorized mode will be the last output mode used before activating strobe.



## DANGER

Do not turn the light directly into human eyes. This may cause blindness for seconds or hurt the eyes.

## WARNING

- Do not use the turbo mode continuously when the environmental temperature is high in case the flashlight body is too hot to hold.

- Ensure battery is inserted with the negative (-) end pointing to the head of the flashlight (LED side).